



HOLL'S

COMFORT DESIGN SAUNAS



Utopia



*Read this manual carefully before using your sauna for the first time.
We recommend you keep it in a safe place for future reference.*

**Write down and keep the serial numbers of the sauna as well as the
purchase invoice.
They may be requested from you during your after-sales service
request.**

RECOMMENDATIONS

- Install the sauna on a perfectly flat floor.
- The sauna must remain in a dry area.
- Do not use it near a source of water (bath, damp floor, swimming pool).
- Do not use liquid cleaning products.
- Disconnect the sauna before cleaning and use a wet rag. (see Maintenance section)
- Protect the sauna's electrical cable to avoid it being crushed or pinched.
- Prior to replacing certain components, ensure that they are specified by the manufacturer or that they have the same features as the original parts. Incorrect replacement can cause a fire, a shortcircuit or damage to the sauna. We strongly recommend using a qualified technician.
- To avoid the risk of burns or electric shocks, do not use any metal tools.
- Do not put animals in the sauna.
- Do not leave the sauna switched on without supervision.
- Do not leave the sauna switched on for more than 3 hours at a time to avoid premature deterioration of the equipment. After 3 hours continuous usage, switch off the sauna for at least one hour.
- We recommend that you do not install a locking system on the sauna door.
- Check compliance of your electrical installation prior to connecting your sauna to the power supply.

SAFETY INSTRUCTIONS

IMPORTANT : Please read the safety instructions carefully before installing and using your sauna cabin.

They are essential for your safety, so please adhere strictly to them.

Beware of hyperthermia, heat stroke or heat exhaustion which can be caused or aggravated by noncompliance

with the safety instructions. Symptoms are fever, a rapid pulse, dizziness, fainting, lethargy and numbness in all or part of the body. The effects are: reduced awareness of the heat, ignorance of

imminent risks, loss of consciousness.

The sauna must not be used by :

- Children under 6 years of age.
- People with severe reactions to sunlight.
- Elderly or disabled people.
- People with previous medical conditions such as heart disease, high or low blood pressure, blood circulation problems or diabetes without prior medical advice.
- Pregnant women
- Excessive temperature can endanger the foetus.
- Persons suffering from dehydration, open sores, eye disorders, burns or sunstroke.

In the event of problems involving health, medication or injury to muscles or ligaments, do not use the sauna without previously consulting a doctor and obtaining approval.

If surgical implants are worn, do not use the sauna without previously consulting a doctor and obtaining his approval.

Do not use the sauna after strenuous activity.

Wait 30 minutes for your body to cool down.

Do not spend more than 40 minutes in the sauna at any one time.

Do not consume alcohol or drugs before or during the session.

Do not sleep in the sauna when it is in operation.

To avoid the risk of overheating, connect your sauna to a sufficiently powerful electrical outlet and do not connect other electrical equipment to the same wall socket.

To avoid any risk of electrocution or damage to the sauna, do not use it:

- During thunderstorms.
- If the electrical cable is damaged, it must be replaced by a qualified person.
- If the electrical cable overheats, it must be checked by a qualified person.
- If you have to change a bulb, wait until the sauna is switched off and cooled down.

Dry your hands before connecting or disconnecting the electricity.

Never work with wet hands or feet.

Do not switch the electricity or the heating system rapidly on or off as this could damage the electrical system.

Do not try to repair the sauna by yourself without the agreement of the sauna's distributor or manufacturer.

Unauthorised attempts to repair it will invalidate the manufacturer's warranty.

Do not use any type of detergent inside the sauna.

- Do not pile up or store objects inside or on top of the sauna.

Do not place flammable materials or chemical agents near the sauna.

DESCRIPTION

General features

- Cabin made from Canadian wood
- Hourglass
- Starry sky
- Ventilation grid
- Warranty 2 years electronics, 10 years woodwork
- Steam accessories

Certificates



Complies with current European standards.



Manufacturing process uses no heavy metals.

Common :

- 1 x installation & user manual
- 1 x door handle (internal and external part)
- 1 x Electric Stove Protection Cradle
- 1 x steam sauna accessory pack
(Including thermometer, hygrometer, hourglass, bucket, ladle and light fixture)

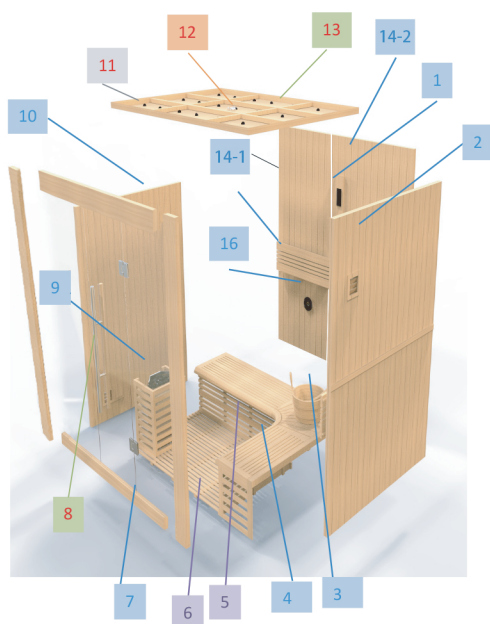

	Name
1	Media control panel
2	Right Panel
3	Wood bucket and spoon
4	Bench
5	Bench support
6	Floor panel
7	Front panel
8	Handle
9	Sauna stove
10	Left panel
11	Sky light
12	Reading light
13	Top panel
14	Rear plate 1, Rear plate 2
15	Backrest
16	Trumpet

INSTALLATION

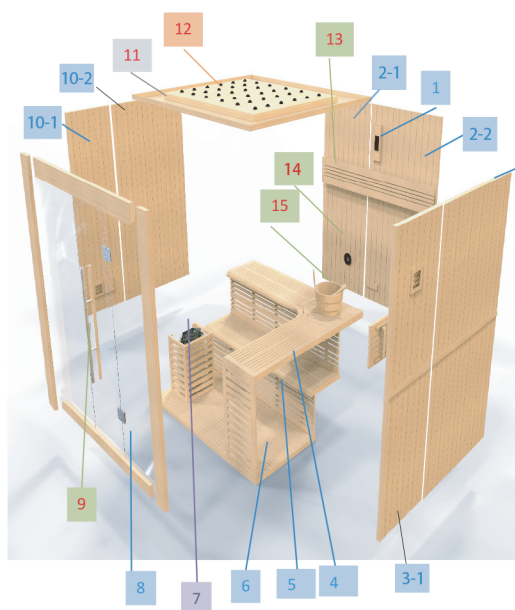

	Name
1	Media control panel
2	Rear plate 1, Rear plate 2
3	Right panel 1, Right panel 2
4	Bench
5	Bench support
6	Floor panel
7	Sauna stove
8	Front panel
9	Handle
10	Left panel 1, Left panel 2
11	Top panel
12	Sky light
13	Backrest
14	Trumpet
15	Wood bucket & spoon

Read the assembly instructions carefully before starting.

Choice of location

Sauna-Center saunas are designed solely for interior installation.

Select a space:

- Inside, in a dry area, on a flat stable floor that can support the weight of your sauna.
- The height must be sufficient for you to reach the ceiling and carry out electrical connections and maintenance.
- Away from any source of water, flames or flammable materials.

Practical advice:

- Note that sauna assembly requires two or three adults.
- Clearly identify each panel before you begin.
- During assembly, position your sauna's mains cable so that it is easily accessible.
- Note that there are variations between the models.

INSTALLATION

Read the assembly instructions carefully before starting assembly.

Electrical connections

The electrical installation of the stove must be carried out by a professional and sized according to the power of the stove. The stove is thus connected with its own electric line, not supplied as it depends on your installation.

This installation must be planned before mounting the cabin.

The entire internal electrical installation of the sauna (lights, LEDs, etc.) is connected directly to the electric stove, the electric cables being pre-wired within the cabin.

Electrical sizing:

Power of the stove (kW)	Sauna volume (m3)		Electrical connection			
			230V 1N	Fuse	400V 3N	Fuse
4,5	3	6	3 x 2,5	1 x 20	5 x 1,5	3 x 10
6	5	8	3 x 2,5	1 x 35	5 x 1,5	3 x 10
8	7	12	3 x 6	1 x 35	5 x 2,5	3 x 16
9	8	14	3 x 10	1 x 50	5 x 2,5	3 x 16

Electrical connection for Harvia Vega stove

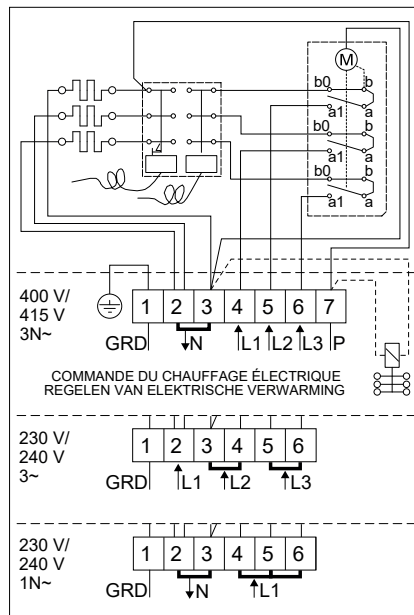

Ignition and delayed start:

Zone A

operation from 1 to 4 hours

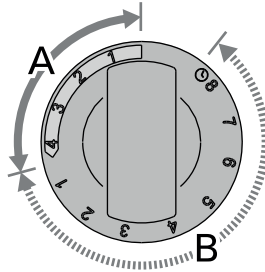

Zone B

Delayed departure from 0 to 8 a.m.

General explanations on the operation of the Harvia stove:

The temperature rise in the sauna is done in stages. A booth takes on average 30 to 45 minutes to reach a temperature of 65-70 °C. During this period, the lava stones store heat.

To reach higher temperatures, it is necessary to add water to the stones. The steam thus generated will allow a gradual and measured increase in temperature.

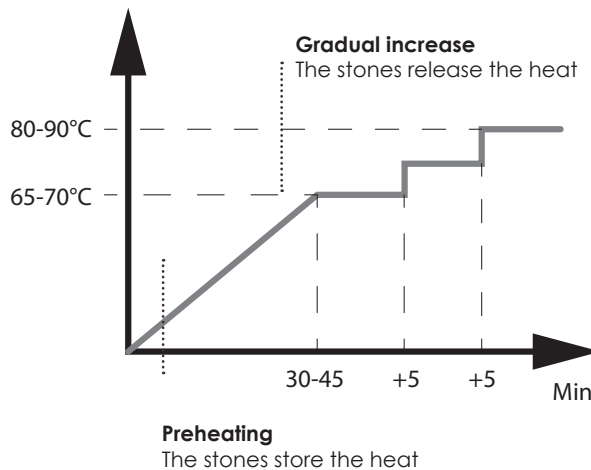

RECTANGULAR MODEL

UTOPIA 4

roof panel	5*40mm	8
front panel	3*16mm	14
front panel	6*75mm	8
rear panel	6*75mm	8
stove stand	4*30mm	8
bench stand	5*40mm	4
backrest	5*40mm	4



5*50mm



5*40mm



4*30mm



3*25mm



6*75mm

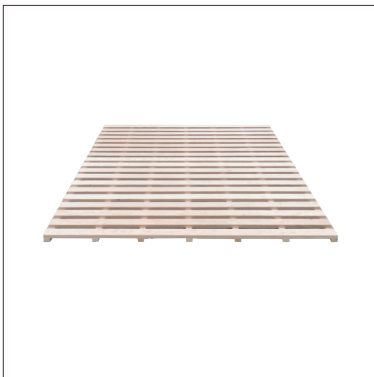

Step 1

Start by positioning the floor on the ground where you want to install the sauna.



Step 2

Install the front panel

(The installation of the front panel can be found on the next page)

ASSEMBLY

UTOPIA 4



Step 3

Position the left and right side panel using the hooks

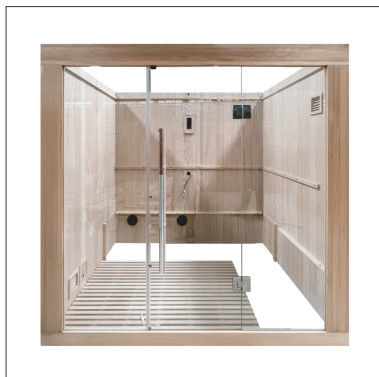
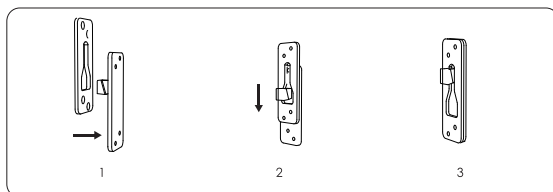

Step 4

Position the rear panel using the the screws provided

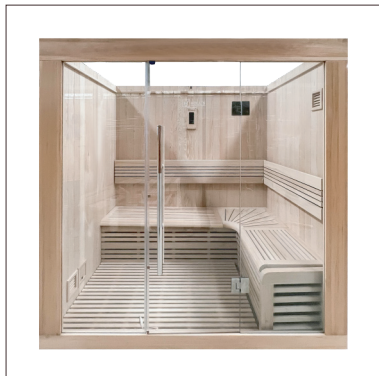

Step 5

Mount the vertical supports of the benches, then position the benches on the cleats and support

ASSEMBLY

UTOPIA 4

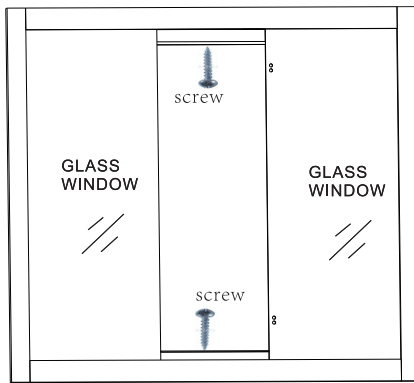
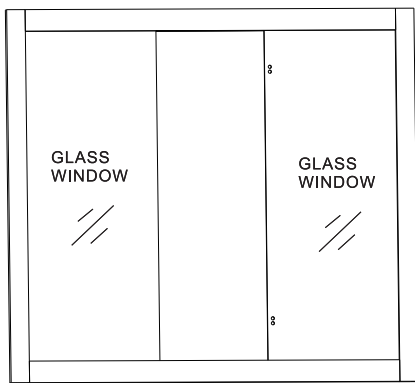
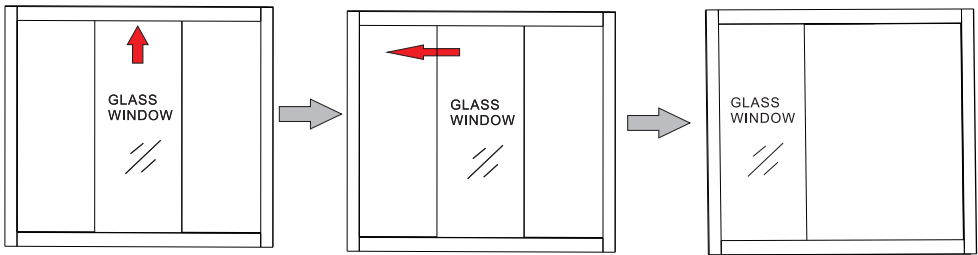
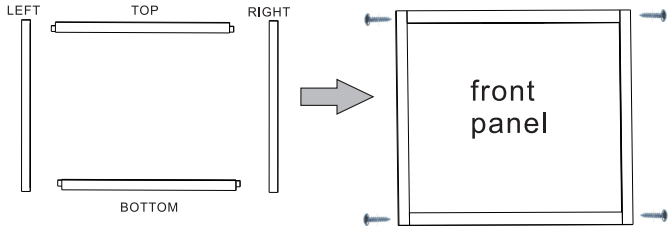
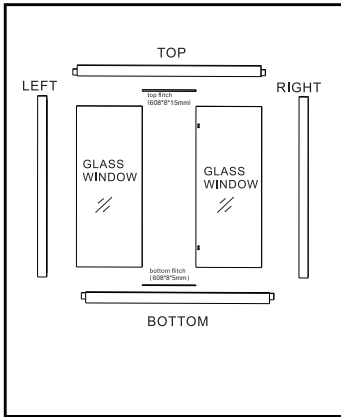

RECTANGULAR MODEL

UTOPIA 4



Step 6

You can screw the benches for more solidity. To do this, screw diagonally.

Also connect the cables between the roof and the rear panel.

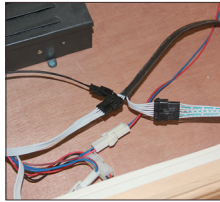

Step 7

Carefully position and fit the roof.



Step 8

position the backrests on the horizontal cleats, then screw them.

ASSEMBLY

UTOPIA 4

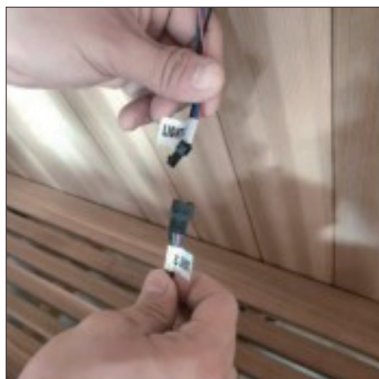

Step 9

Connect the connection plugs of the LED strips of the backrests to the sockets available on the rear panel.



Step 10

Please place and screw the pan support according to the position of the ventilation

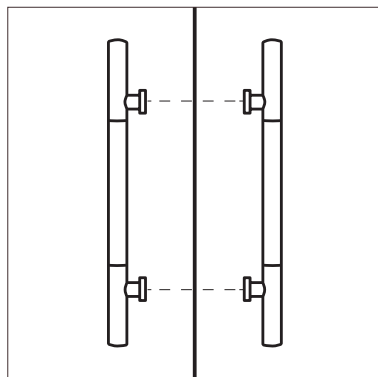

Step 11

On the outside of the door, position the handle in line with the holes provided. Insert the screws through the inside of the door and fix the handle.

RECTANGULAR MODEL

UTOPIA 6

roof panel	5*50mm	16
roof panel	5*40mm	10
front panel	3*16mm	14
front panel	6*75mm	8
rear panel	6*75mm	8
stove stand	4*30mm	8
bench stand	5*40mm	5
backrest	5*40mm	6



5*50mm



5*40mm



4*30mm



3*25mm



6*75mm

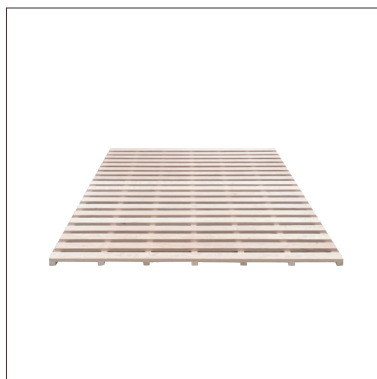

Step 1

Start by positioning the floor on the ground where you want to install the sauna.



Step 2

Position the front panel
(The installation of the front panel can be found on the next page)

ASSEMBLY

UTOPIA 6



Step 4

Position the left and right side panel using the hooks

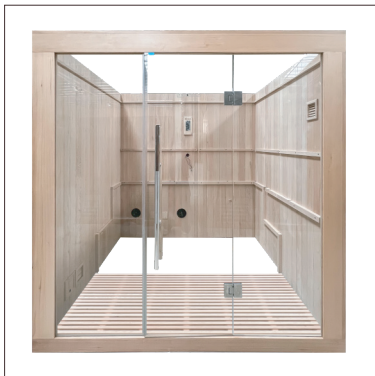
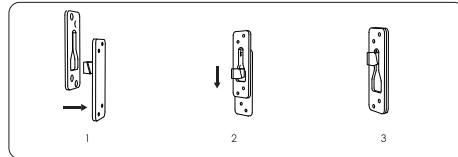

Step 5

Position the rear panel using the the screws provided



Step 6

Position the vertical supports using the pre-installed cleats

ASSEMBLY

UTOPIA 6

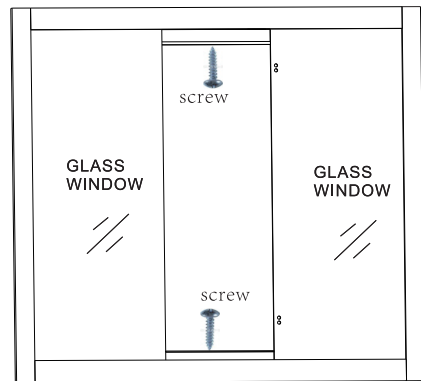
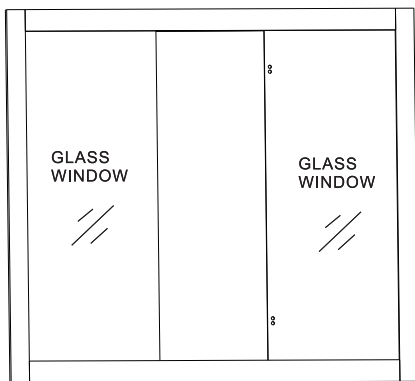
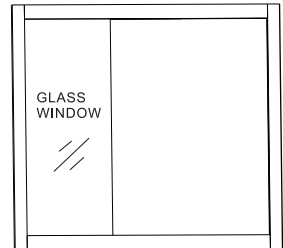
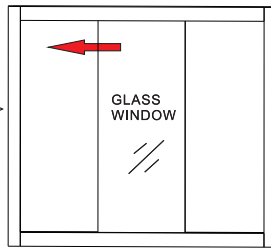
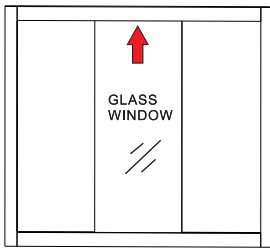
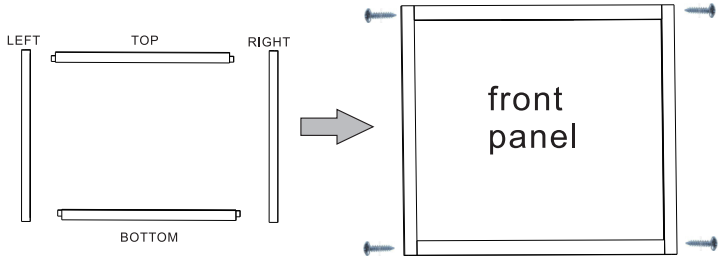
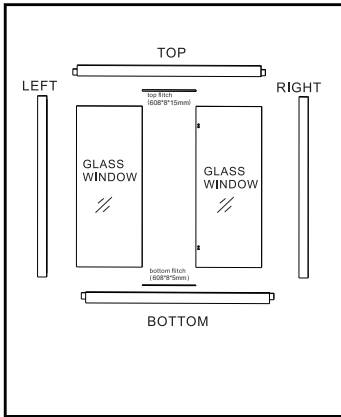

RECTANGULAR MODEL

UTOPIA 6

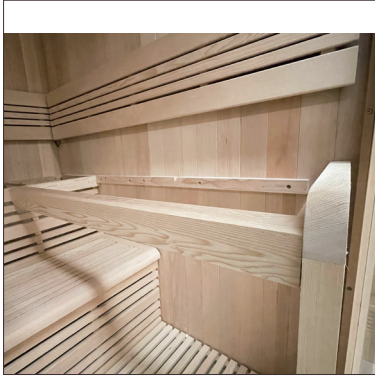

Step 7

Screw the specific cleat to the right bench seat

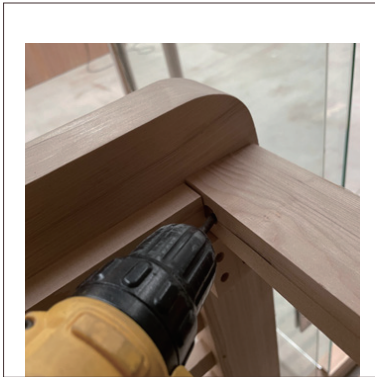

Step 8

Screw the specific cleat to the right bench seat

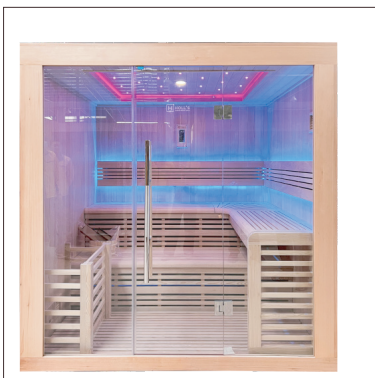

Step 9

Place the benches on the fixed supports

ASSEMBLY

UTOPIA 6

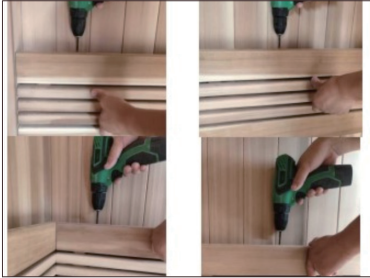

Step 10

position the backrests on the horizontal cleats, then screw them.

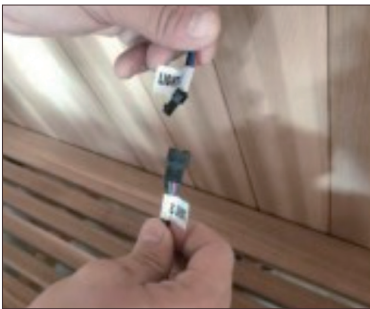

Step 11

Connect the connection plugs of the LED strips of the backrests to the sockets available on the rear panel.

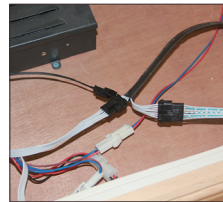

Also connect the cables between the roof and the rear panel.



Step 12

Please place and screw the pan support according to the position of the ventilation

Connect the stove electrically as well as the electrical elements of the cabin, then install it and add the stones on top in a homogeneous manner.

Do not drop stones into the stove.

Do not wedge the stones between the resistances.

The stones must not be too tight, they must support each other without resting on the resistances.

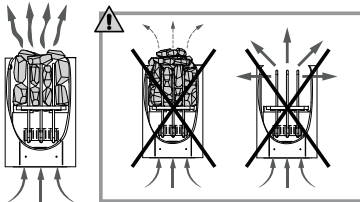

CONTROL PANEL



1、 Power on

When the system is in standby mode, tap the key , the system will be switched on and all the lights will be turned on.

2、 Press the key to control the colour light on/off. Under the condition of colour light on, long press the colour light key for 3 seconds, the display will show "L1-L9", which can change the colour of the LED light, tap and press once to change a colour, it can be cyclic and memorized (L1 full light L2 red and blue L3 blue L4 blue and green L5 green L6 green and red L7 red L8 jump change L9 gradient). In the multimedia on state, 30 seconds did not respond to the key, the system exits the light control mode, the display shows the multimedia logo.

3、 Tap the key , you can control the LED light on/off.

4、 Audio function

(1) Tap " " key, you can open the Bluetooth function, the screen shows "bLU"

Note: During Bluetooth pairing, Bluetooth name "Sauna", no password is needed.

Press TUN+- to select song, press VOL+- to adjust volume.

(2) Tap FM to switch on/off the radio, the digital tube shows the radio frequency. In the state of switching on the radio, long press FM to search stations automatically and save the stations. Press TUN+- to select the radio station, and press VOL+- to adjust the volume.

5.Child lock function

If there is no key operation for more than 3 minutes, the system is in lock state. At this time, press any other key, the screen displays "LOC", at this time you need to long press the child lock key for 3 seconds to unlock.

MAINTENANCE

Disconnect the cabin's power supply cable before undertaking any work.

Problems identified	Possible reasons	Solutions
Electric stove does not heat up.	Power supply cable disconnected	Check power supply cable connection
	The general power supply is cut	Check that the switchboard and wall plug are working
	Stove is overheat protected.	Refer to the electric stove manual

SERVICING & WARRANTY

Servicing

1. Disconnect your sauna.
2. Use a vacuum cleaner to remove dust from crevices in the woodwork.
3. Clean the cabin with a damp cotton cloth and use a small amount of soap if necessary. Rinse with a damp cloth.
4. Wipe with a dry cloth.

IMPORTANT

Do not use benzene, alcohol, chemical agents or strong detergents on the sauna since chemical products can damage the wood and its protective coating. Do not spray water on your sauna.

Practical advice:

To extend the life of your sauna, we recommend that you apply linseed oil to the benches, back rests and flooring of your cabin with a lint-free cloth. If your sauna's flooring or bench are indelibly marked, rub them lightly with sandpaper.

Warranty

All the components of France-Sauna saunas are guaranteed for 2 years and wood 10 years..

The warranty comes into force on the date of dispatch (corresponding to the date the invoice is issued).

The warranty does not apply in the following cases :

- Malfunction or damage arising from installation, usage or repair that are not in compliance with the safety instructions.
- Malfunction or damage arising from conditions that are unsuitable for the equipment's originally intended purpose.
- Damage arising from negligence, accident or force majeure (thunderstorm or bad weather).
- Malfunction or damage arising from the use of non-authorized accessories.

The warranty does not cover the costs linked to returning the cabin or part of its components to our workshops of. Under the warranty, in the event of a breakdown, the items deemed defective by our technicians will be exchanged. Information and explanations required for their installation will be provided by one of our technicians. Costs linked to the use of subcontract labour provided by a third party cannot be covered by France-sauna.